

1and1.com Domain instructions PDF

To change the Nameservers at 1and1 :

1. Go to https://www.1and1.com/login?__lf=Static
2. Log in to your 1and1 Account

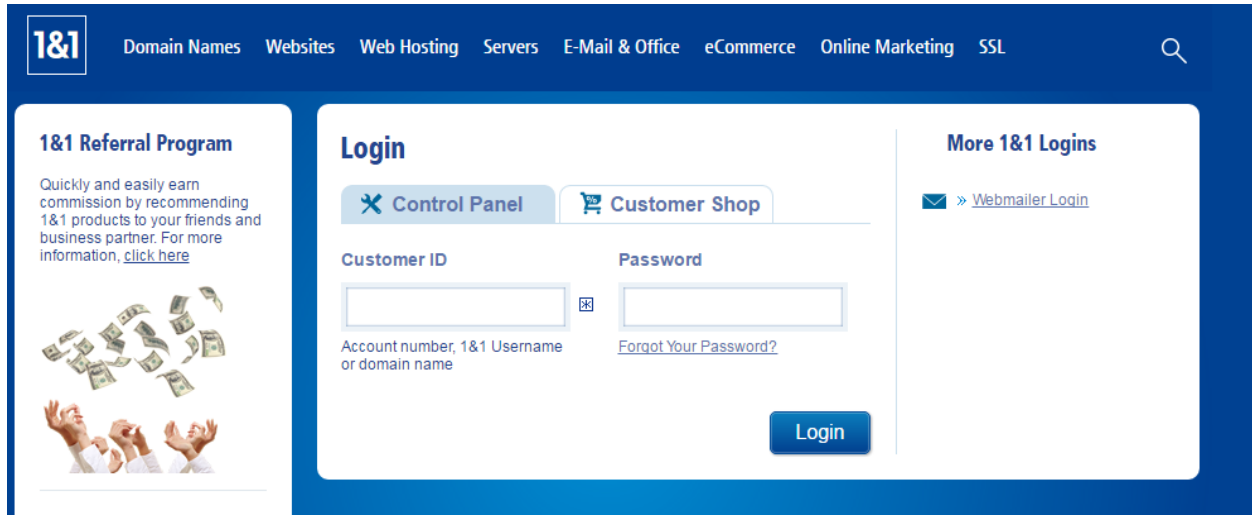

3. Click **Manage Domain**

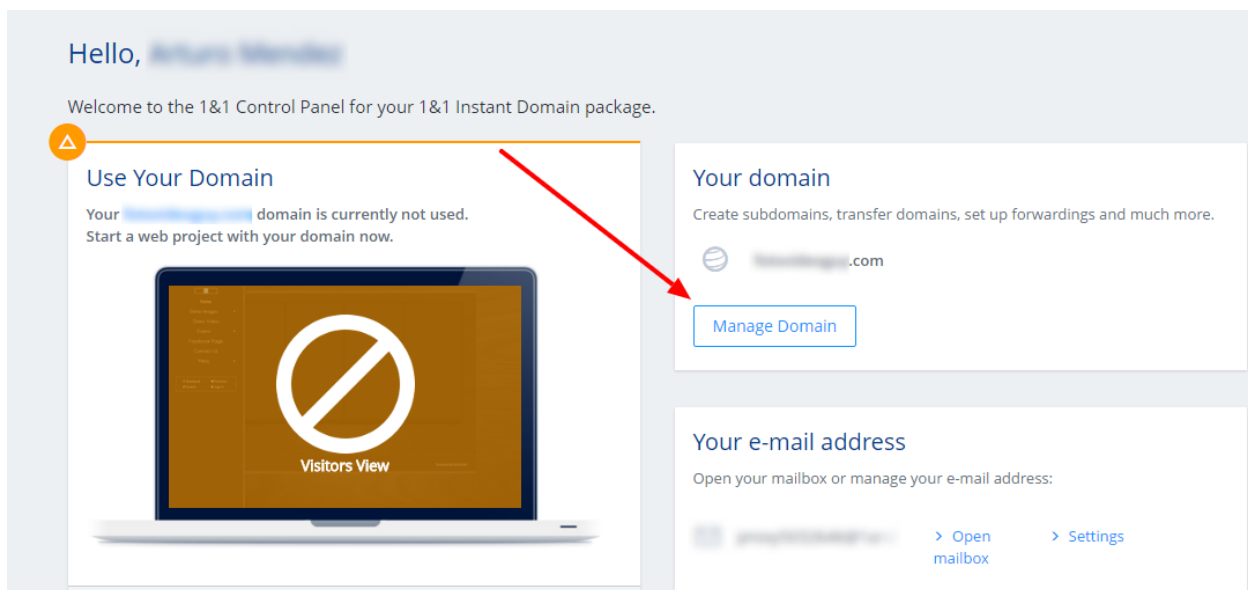

4. Under Domain Settings - Click 'Edit DNS Settings. (if you are going to also be entering in MX records, make note of them on this page.)

The screenshot shows the 'Domain' management interface for a domain. At the top, it displays the domain name, a toggle switch for 'Use your domain', and a 'Renews in 5 months (09/01/2016)' notice. Below this, there are three main sections: 'Domain Details', 'DNS Settings', and 'Domain Settings'. The 'Domain Details' section shows 'Destination: Webspaces', 'Target: /', 'Type: Additional domain', and 'Status: Active'. The 'DNS Settings' section lists '1&1 name servers', an 'A 209.80.10.130' record, and two 'MX' records: 'mx00.1and1.com' and 'mx01.1and1.com'. A purple arrow points to the 'mx01.1and1.com' record. The 'Domain Settings' section includes options like 'Edit Domain Settings', 'Edit Destination', 'Edit Domain Contacts', 'Edit DNS Settings' (highlighted with a red box), 'Manage Subdomains', 'Additional Features', and 'Transfer/Cancel Domain'. A red arrow points from the 'Edit DNS Settings' link to the 'Edit DNS Settings' link in the 'Domain Settings' section.

4. Under Name Server Settings, click 'Other Nameservers'.

The screenshot shows the 'Name Server Settings' page. It starts with a 'Please note:' section stating: 'If you want to use this domain with a 1&1 product, you need to use the 1&1 default settings.' Below this, there are two radio button options for 'Name servers': '1&1 name servers' (which is selected) and 'Other name servers'. A red arrow points to the 'Other name servers' radio button. To the right, there is a button labeled 'Use 1&1 Default Settings' with a help icon.

A/AAAA and CNAME Records

5. Enter ns1.ifp3.com for Name Server 1. Add an additional Nameserver. Then enter ns2.ifp3.com in the Name Server 2 box that appears. Click Save.

Name Server Settings ?

Please note:
If you want to use this domain with a 1&1 product, you need to use the 1&1 default settings.

Name servers: 1&1 name servers
 Other name servers

Name server 1:

Additional name servers: ▼

Name server 2:

Name server 3:

Name server 4:

● Note: It may take up to 48 hours for changes to the DNS settings to propagate throughout the entire domain name system.

[Use 1&1 Default Settings](#) ?

[Cancel](#)

[Reset](#)

[Save](#)

6. Click 'Yes' when asked if you want to modify DNS settings

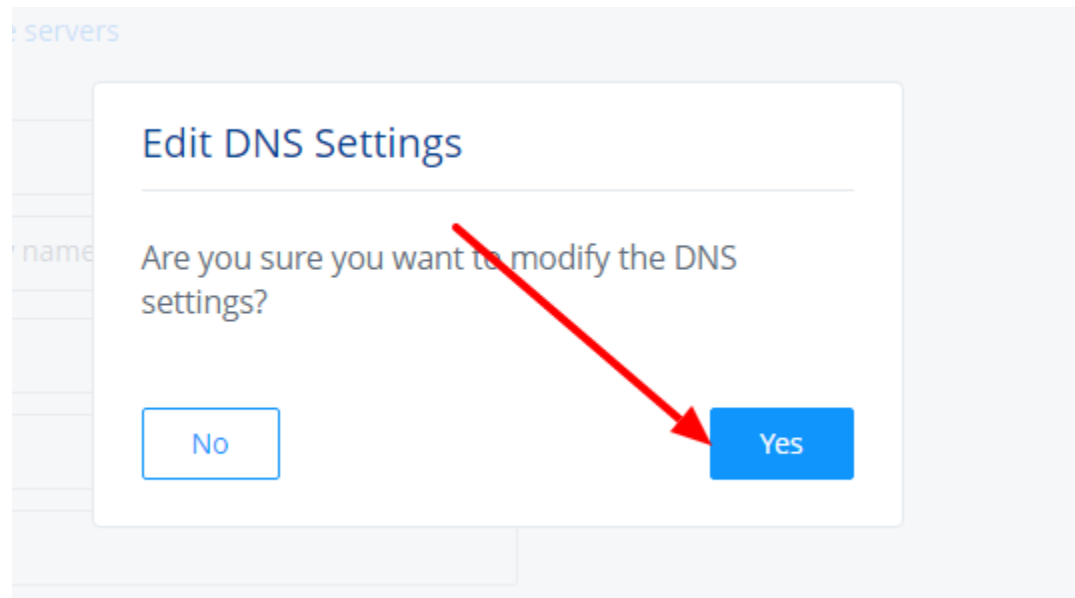

7. Notify Support that the changes have been made via the support ticket in your Admin. If you are using an email associated with this Domain name, enter in your MX Records in your Admin.